



Alice

www.catamaranalice.com



Your holidays with this brand new Lagoon 46, build 2020, will be unforgettable. Come onboard the Catamaran Alice for a lifetime experience.

- ✓ Four large double cabins with ensuite facilities (8-10 guests).
 - ✓ Crew of two members (Captain and Chef/Hostess).
 - ✓ Crew quarters completely separated.
- ✓ Fully Airconditioned, at all cabins and at the saloon/galley area.
- ✓ With its double access, the Flybridge is dedicated both to manoeuvring and relaxing.
 - ✓ The centered helm station offers protection and visibility.
- ✓ Fully equipped galley with more storage space, extra fridge and deep freezer.
 - ✓ Teak deck on the aft cockpit.
 - ✓ Hydraulic lifting/swimming platform for the tender.
 - ✓ Icemaker.
 - ✓ Watemaker: up to 200 liters per hour.





- ✓ Electrical toilets.
- ✓ Corian floors.
- ✓ Hair dryers.





- ✓ Fully equipped galley with dishwasher, 155 liters fridge and 90 liters freezer.
- ✓ LED tv 37" and Dolby surround HIFI.
- ✓ Extra double berth in Saloon in case of 10 guests.



- ✓ The new design accomplished the perfect balance between the different living spaces.
- ✓ The 46 combines modular front and aft cockpits, a complete cooking area at the back, a practical and safe access to the sea, still giving Nauta Design large volumes in the salon to fully express themselves.
- ✓ Defenately the next step to the perfect liveaboard.



- ✓ Teak deck on the aft cockpit.
- ✓ Icemaker.
- ✓ Comfortable cushions on all areas.
- ✓ Poufs and Sunbeds for maximum relaxation.
- ✓ Easy access to the sea, only two steps away.
- ✓ Hot and cold water shower on the deck.



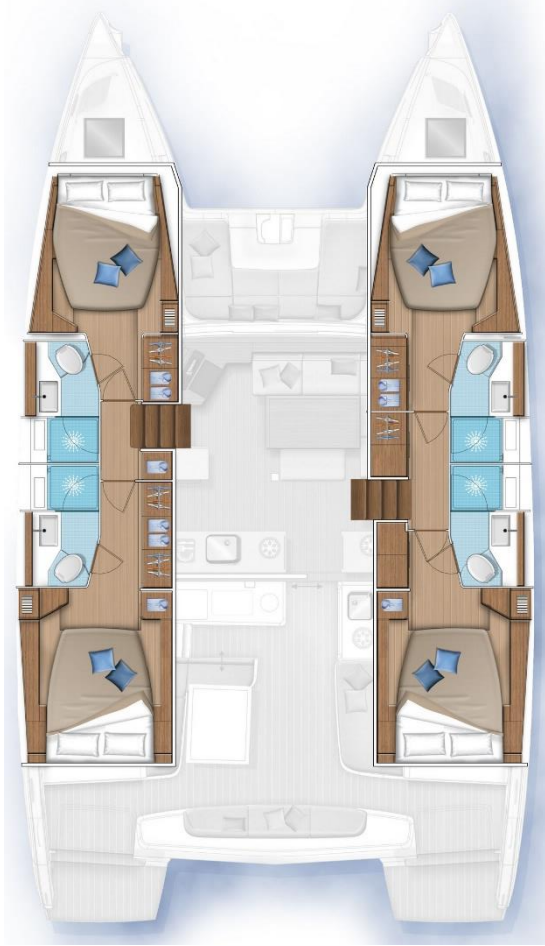

Alice

www.catamaranalice.com

SPECIFICATIONS

- Length overall - 13,99 m / 45'11"
- Beam overall - 7,96 m / 26'10"
- Draught - 1,30 m / 4'3"
- Air draught - 23,99 m / 78'8"
- Light displacement (EEC) - 16,6 t / 36,603 Lbs
- Engines - 2 x 57 HP
- Generator Onan 11 KWA
- Fuel capacity - 2 x 520 l / 2 x 137 US gal
- Sail area - 140,1 m² / 1,507 sq. ft.
- Full battened - 89,6 m² / 965 sq. ft.
- Self tacking jib - 50,5 m² / 543 sq. ft.
- Fresh water capacity - 2 x 300 l / 2 x 79 US gal
- No. of berths - 4 + 2 for the crew & 1 extra double convertible birth in the salon
- EC certification - A Class : 12
- Fully Airconditioned
- Tender 3,40 m with 25 Outboard fourstroke engine
- Hydraulic Gangway
- Watermaker up to 200 liters per hour
- Icemaker
- Hydraulic lifting/swimming platform for the tender
- Fully electronic and wind instruments equipment, GPS, VHF, 24nm Radar, Autopilot