

H I G H J I N K S



Fountaine Pajot, in association with the Berret Racoupeau design office, has produced a definitively elegant and innovative catamaran with a unique, contemporary design. Specifically designed for ocean cruising as well as unforgettable family holidays, the Sanya 57 affords all the pleasures of the sea, with the distinctive comfort, fixtures and services you've come to expect from our Flagship Class.



Outdoor Area



Outdoor Dining



Saloon and Kitchen Area



Cabins

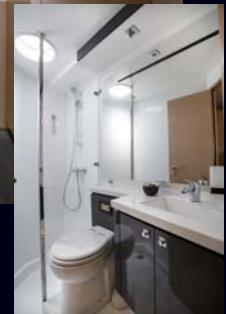

Water Toys



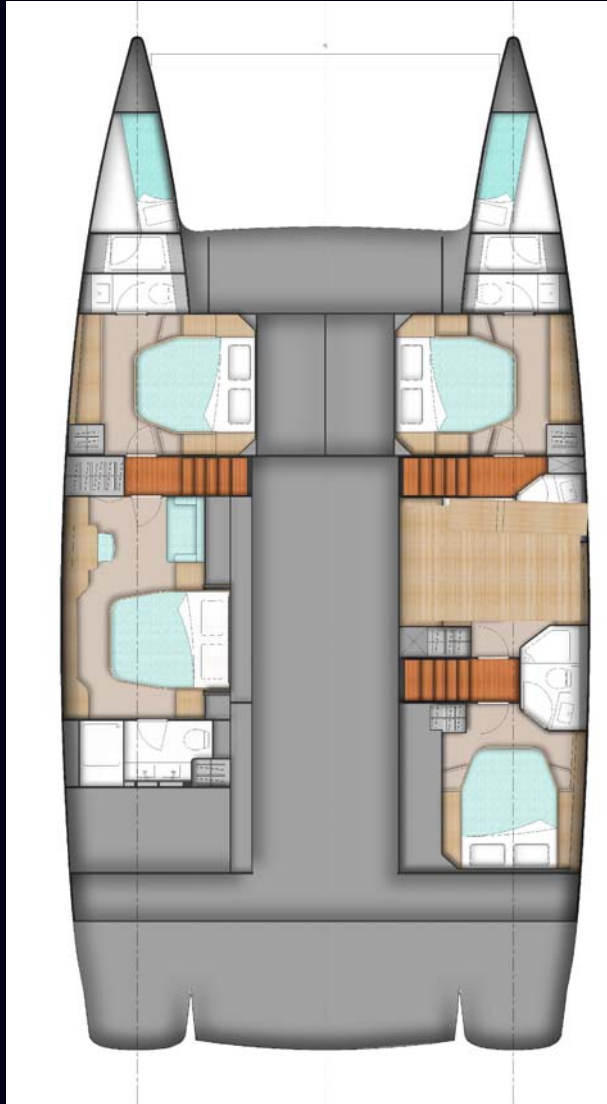

SANYA 57

Longueur hors tout / Length over all 17.26 m / 57 ft

Largeur hors tout / Beam over all 8.88 m / 29.3 ft

Tirant d'eau / draft 1.40 m / 4.6 ft

Déplacement / Displacement 21 t / 46200 lbs

Surfaces de voile / sail area :

Génois / Genoa 52 m² (approx.) / 560 sq ft (approx.)

Grand Voile / Main sail 89 m² (approx.) / 957 sq ft (approx.)

Option greement performance / Performance Option :

Génois / Genoa 62 m² (approx.) / 666 sq ft (approx.)

Grand Voile / Main sail 108 m² (approx.) / 1160 sq ft (approx.)

Motorisation standard / Standard power 2 x 75 CH / HP

Option Motorisation 2 x 110 CH / HP

Capacité des réservoirs / Tank capacity :

Eau douce / Fresh water 1050 l (approx.) / 278 US gallons (approx.)

Gasoil / Fuel 1100 l (approx.) / 291 US gallons (approx.)

Accommodations:

1 owners suite, 3 double cabins – all cabins with ensuite facilities.

Water toys: tubes, banana, snorkeling equipment, kayak, paddle board, wake board and fishing gear